



| VIABILITA' PUBBLICA | | |
|---------------------|-----------------------------|------------|
| PUNTO | COORDINATE | SUPERFICIE |
| VB.01 | X=607599,9507 Y=950734,1013 | |
| VB.02 | X=607600,1194 Y=950733,5287 | |
| VB.03 | X=607605,9426 Y=950715,1651 | |
| VB.04 | X=607610,7035 Y=950702,9817 | |
| VB.05 | X=607617,0140 Y=950691,5239 | |
| VB.06 | X=607660,3341 Y=950623,7707 | |
| VB.07 | X=607662,8243 Y=950618,3953 | |
| VB.08 | X=607663,7899 Y=950612,5503 | |
| VB.09 | X=607665,3109 Y=950606,0891 | |
| VB.10 | X=607668,2550 Y=950600,7501 | |
| VB.11 | X=607671,2612 Y=950598,4935 | |
| VB.12 | X=607671,7156 Y=950594,4935 | |
| VB.13 | X=607676,7854 Y=950590,3476 | |
| VB.14 | X=607682,7858 Y=950581,2614 | |
| VB.15 | X=607724,5690 Y=950561,3303 | |
| VB.16 | X=607760,0702 Y=950542,4315 | |
| VB.17 | X=607763,0993 Y=950445,6472 | |
| VB.18 | X=607740,0552 Y=950441,3197 | |
| VB.19 | X=607752,7391 Y=950432,2166 | |
| VB.20 | X=607728,8072 Y=950547,3646 | |
| VB.21 | X=607753,6929 Y=950565,2516 | |
| VB.22 | X=607742,8329 Y=950580,5372 | |
| VB.23 | X=607678,6295 Y=950580,8177 | |
| VB.24 | X=607627,4516 Y=950572,8079 | |
| VB.25 | X=607665,6261 Y=950572,8440 | |
| VB.26 | X=607661,2149 Y=950569,1820 | |
| VB.27 | X=607658,9920 Y=950535,9988 | |
| VB.28 | X=607651,0622 Y=950536,5211 | |
| VB.29 | X=607645,9261 Y=950536,7693 | |
| VB.30 | X=607645,9261 Y=950570,0442 | |
| VB.31 | X=607643,5358 Y=950576,8390 | |
| VB.32 | X=607651,6361 Y=950583,1292 | |
| VB.33 | X=607649,0604 Y=950587,4468 | |
| VB.34 | X=607645,0401 Y=950589,7335 | |
| VB.35 | X=607639,9984 Y=950609,2466 | |
| VB.36 | X=607639,9984 Y=950616,3928 | |
| VB.37 | X=607558,0271 Y=950697,8139 | |
| VB.38 | X=607560,4020 Y=950603,5204 | |
| VB.39 | X=607638,4408 Y=950619,7206 | |
| VB.40 | X=607653,6185 Y=950687,4838 | |
| VB.41 | X=607654,0153 Y=950699,8009 | |
| VB.42 | X=607610,6952 Y=950712,8891 | |
| VB.43 | X=607603,9114 Y=950722,0807 | |
| VB.44 | X=607598,7934 Y=950722,0807 | |
| VB.45 | X=607595,8915 Y=950722,0807 | |

SUB COMPARTO B 4.245,30 m²

| ACCESSI E DISTRIBUZIONE | | |
|-------------------------|-----------------------------|------------|
| PUNTO | COORDINATE | SUPERFICIE |
| DB.01 | X=607625,8547 Y=950677,6989 | |
| DB.02 | X=607629,0937 Y=950679,3479 | |
| DB.03 | X=607631,0177 Y=950675,7285 | |
| DB.04 | X=607624,2144 Y=950692,6973 | |
| DB.05 | X=607631,4703 Y=950671,3174 | |
| DB.06 | X=607610,5359 Y=950659,3342 | |
| DB.07 | X=607628,6935 Y=950661,6837 | |
| DB.08 | X=607625,4845 Y=950661,2554 | |
| DB.09 | X=607621,5205 Y=950663,3488 | |
| DB.10 | X=607613,2738 Y=950663,7581 | |
| DB.11 | X=607620,3719 Y=950660,6266 | |
| DB.12 | X=607643,5565 Y=950638,2271 | |
| DB.13 | X=607650,7198 Y=950638,7054 | |
| DB.14 | X=607650,7198 Y=950638,7054 | |
| DB.15 | X=607651,9285 Y=950630,2027 | |
| DB.16 | X=607651,9285 Y=950630,2027 | |
| DB.17 | X=607658,7144 Y=950628,3040 | |
| DB.18 | X=607649,9887 Y=950627,6851 | |
| DB.19 | X=607652,1263 Y=950626,0346 | |
| DB.20 | X=607648,9173 Y=950629,6997 | |
| DB.21 | X=607641,7066 Y=950633,1090 | |
| DB.22 | X=607641,7066 Y=950633,1090 | |
| DB.23 | X=607561,6459 Y=950604,4499 | |
| DB.24 | X=607578,1837 Y=950600,8543 | |
| DB.25 | X=607574,2434 Y=950602,2545 | |
| DB.26 | X=607571,6974 Y=950604,1294 | |
| DB.27 | X=607565,8162 Y=950600,3390 | |
| DB.28 | X=607564,9202 Y=950596,4018 | |
| DB.29 | X=60756,4511 Y=950592,8062 | |
| DB.30 | X=60781,9889 Y=950594,2094 | |
| DB.31 | X=60768,8617 Y=950585,6388 | |
| DB.32 | X=60768,8617 Y=950584,2387 | |
| DB.33 | X=60761,9473 Y=950578,1051 | |
| DB.34 | X=607394,6214 Y=950562,3824 | |
| DB.35 | X=607394,6214 Y=950562,3824 | |
| DB.36 | X=60721,2236 Y=950562,3824 | |
| DB.37 | X=60711,0513 Y=950561,5159 | |
| DB.38 | X=60710,6836 Y=950561,5159 | |
| DB.39 | X=60710,6836 Y=950561,5159 | |
| DB.40 | X=60708,6836 Y=950561,5159 | |
| DB.41 | X=60708,6836 Y=950561,5159 | |
| DB.42 | X=60708,6836 Y=950561,5159 | |
| DB.43 | X=60708,6836 Y=950561,5159 | |
| DB.44 | X=60708,6836 Y=950561,5159 | |
| DB.45 | X=60708,6836 Y=950561,5159 | |
| DB.46 | X=60708,6836 Y=950561,5159 | |
| DB.47 | X=60708,6836 Y=950561,5159 | |
| DB.48 | X=60708,6836 Y=950561,5159 | |
| DB.49 | X=60708,6836 Y=950561,5159 | |
| DB.50 | X=60708,6836 Y=950561,5159 | |
| DB.51 | X=60708,6836 Y=950561,5159 | |
| DB.52 | X=60708,6836 Y=950561,5159 | |
| DB.53 | X=60708,6836 Y=950561,5159 | |
| DB.54 | X=60708,6836 Y=950561,5159 | |
| DB.55 | X=60708,6836 Y=950561,5159 | |
| DB.56 | X=60708,6836 Y=950561,5159 | |
| DB.57 | X=60708,6836 Y=950561,5159 | |
| DB.58 | X=60708,6836 Y=950561,5159 | |
| DB.59 | X=60708,6836 Y=950561,5159 | |
| DB.60 | X=60708,6836 Y=950561,5159 | |
| DB.61 | X=60708,6836 Y=950561,5159 | |
| DB.62 | X=60708,6836 Y=950561,5159 | |
| DB.63 | X=60708,6836 Y=950561,5159 | |
| DB.64 | X=60708,6836 Y=950561,5159 | |

SUB COMPARTO B 421,29 m²

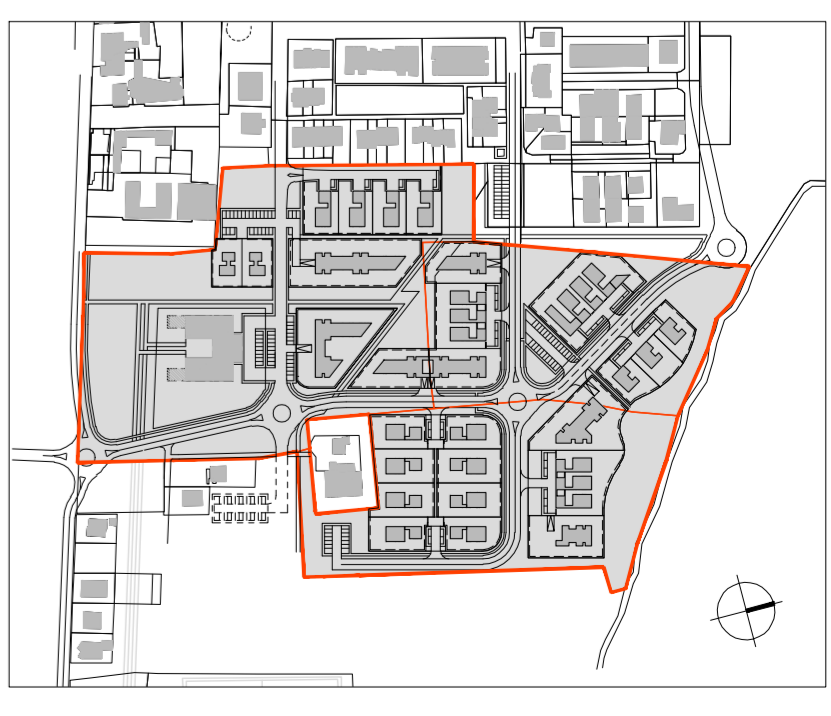

REGIONE EMILIA ROMAGNA
 Provincia di Parma
 Comune di MORTERANARO

progettista
 ing. Alfredo Soncini
 arch. Caterina Baietti

cliente
 Istituto Tecnico "Gianni Di Gregorio"
 opera di urbanizzazione
 ing. Alfredo Soncini
 arch. Angelo Ombellini

ELABORATO
 CONTRADDISTO E
 APPROVATO

edifico
 denominazione
 P-04.1b

SCALA: 1/1000
 REL. DATA: 02/07/2022
 REL. DATA: 02/07/2022
 REL. DATA: 02/07/2022