

PONTILE GALLEGGIANTE (scala 1:100)

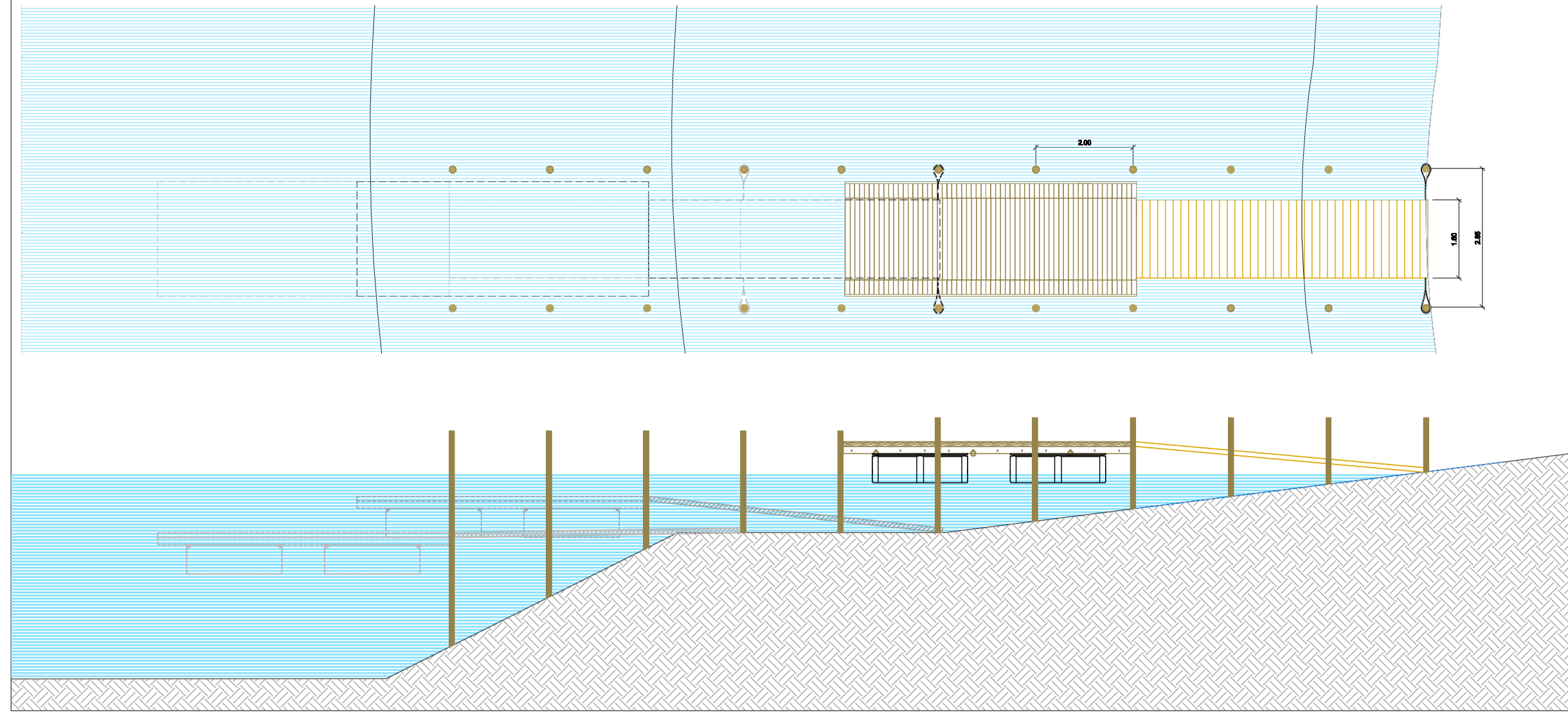

VISTA LATERALE (scala 1:50)

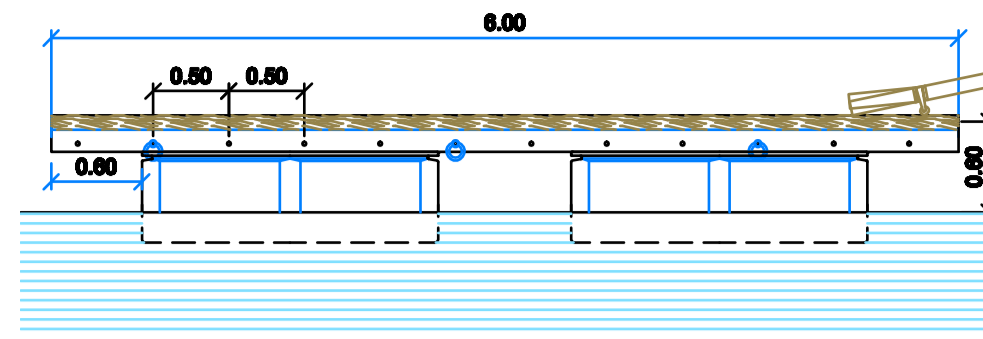

SEZIONE TRASVERSALE (scala 1:50)

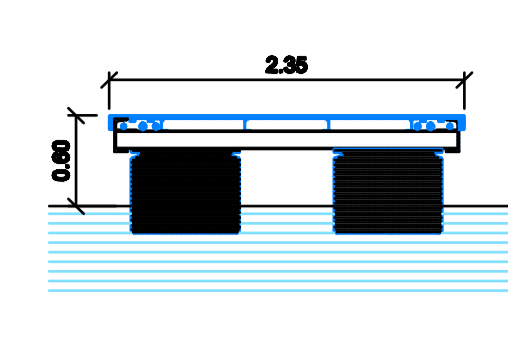

PIANTA (scala 1:50)

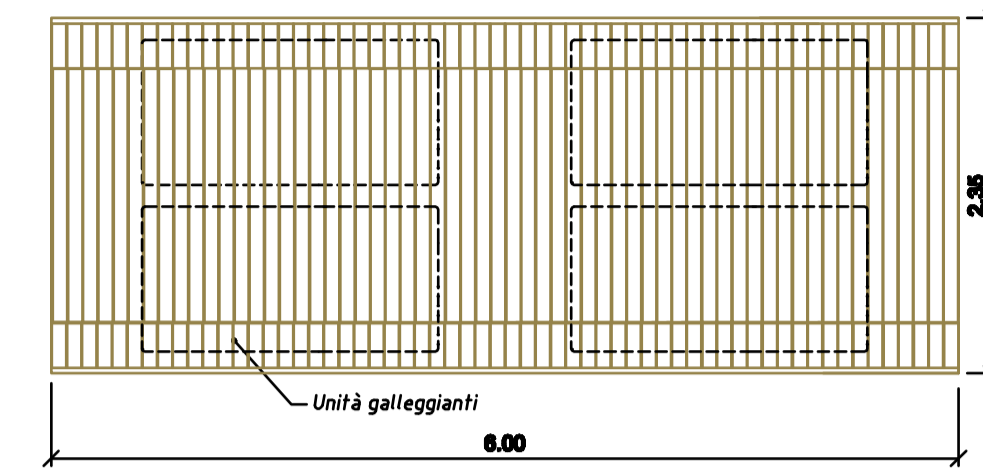

PISTA CICLOPEDONALE (larghezza max 2.0 m) DA REALIZZARE SULLA SOMMITÀ ARGINALE

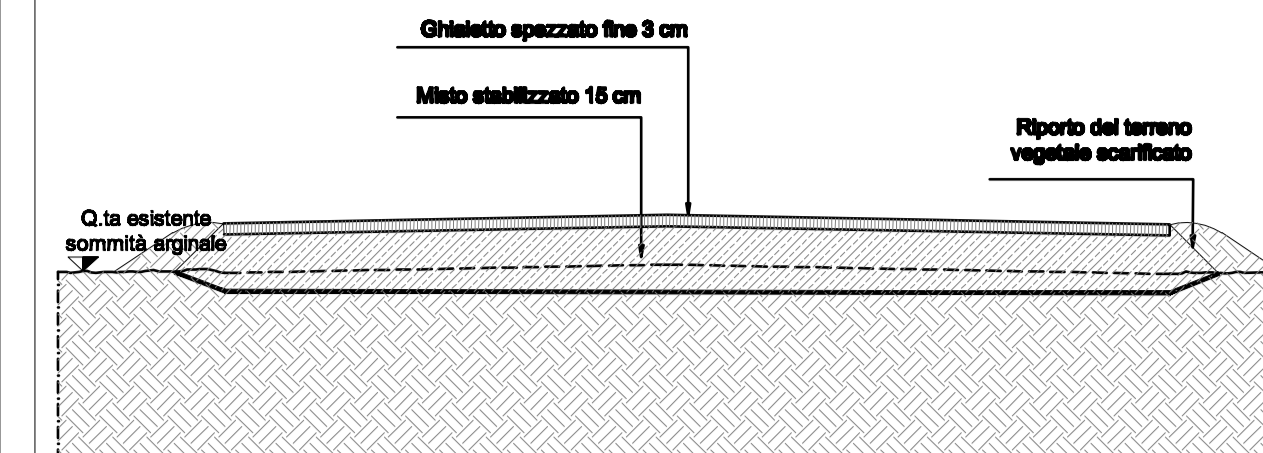

SCALA 1:20

PISTA CICLOPEDONALE (larghezza max 2.0 m) E AREE DI SOSTA DA REALIZZARE NELL'AMBITO DEL POLO ESTRATTIVO

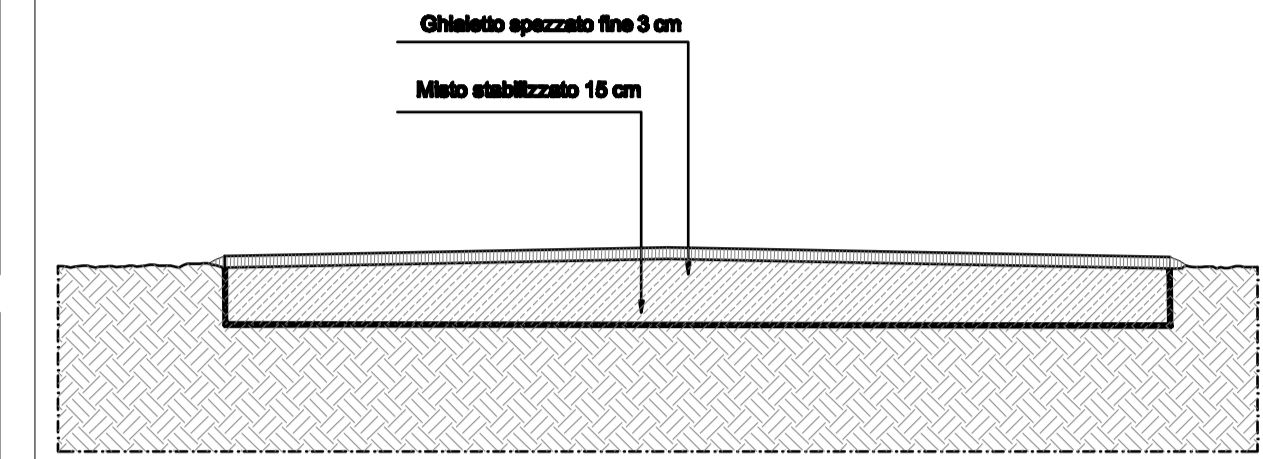

SCALA 1:20

PISTA CARRABILE E CICLOPEDONALE (larghezza 5 m) DI ACCESSO AL POLO

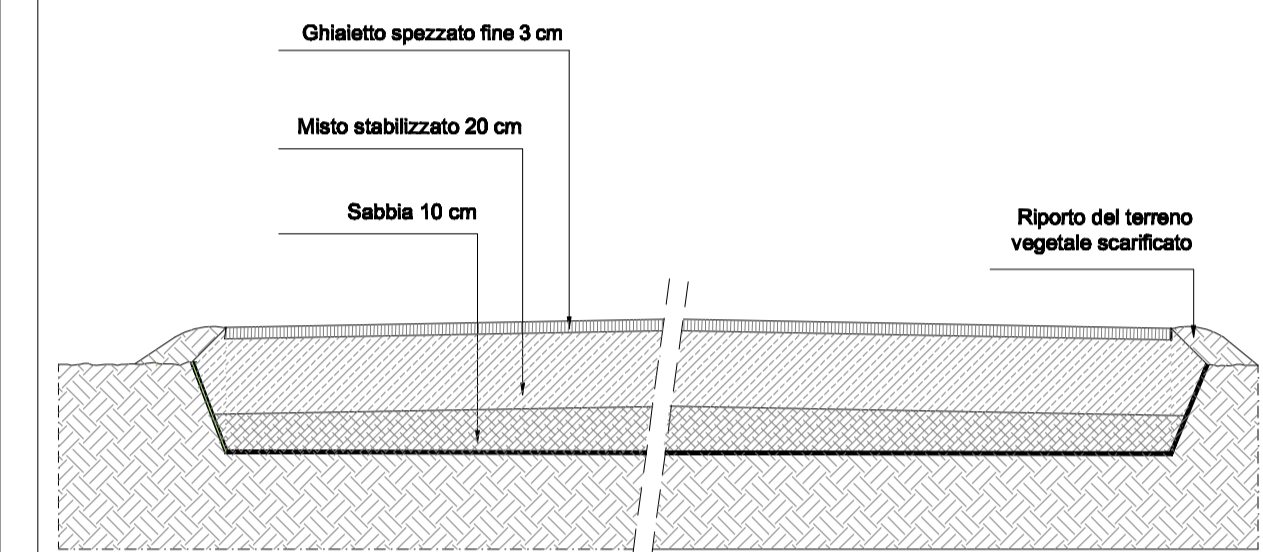

SCALA 1:20

AREE GIOCO

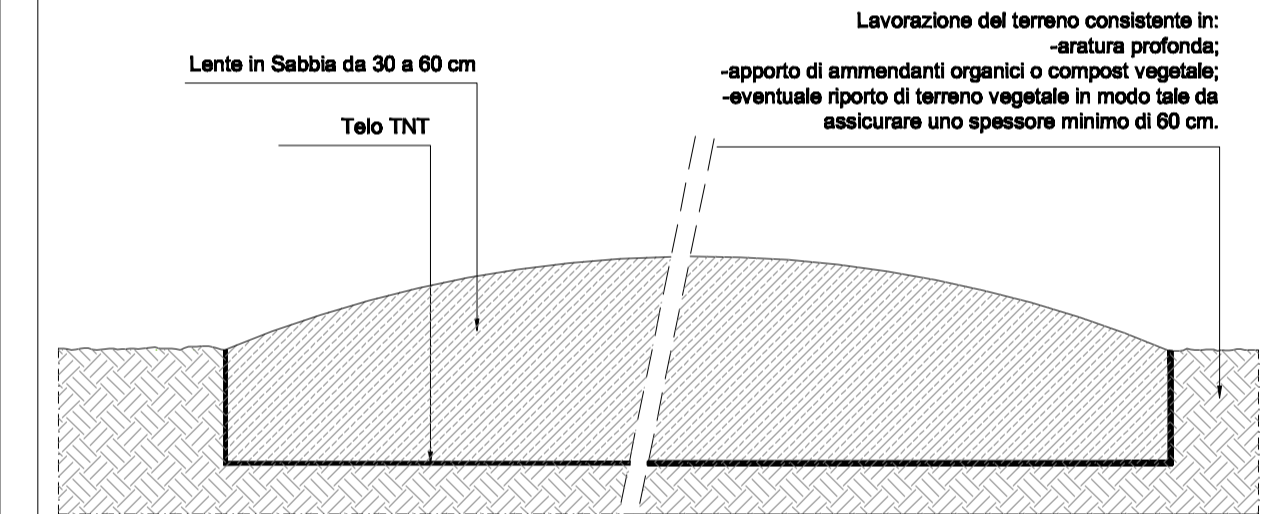

SCALA 1:20

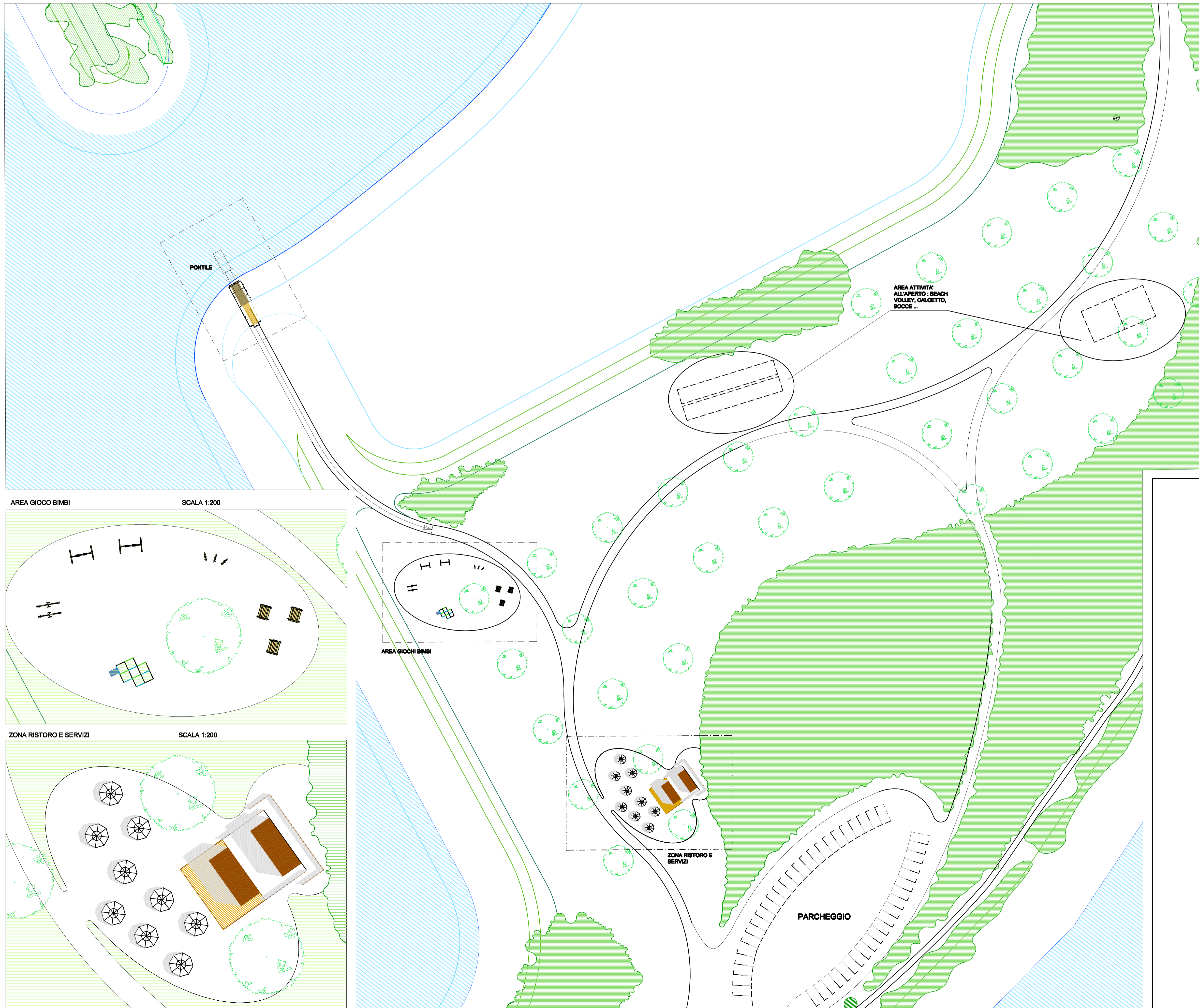

AREA GIOCO BIMBI (scala 1:200)

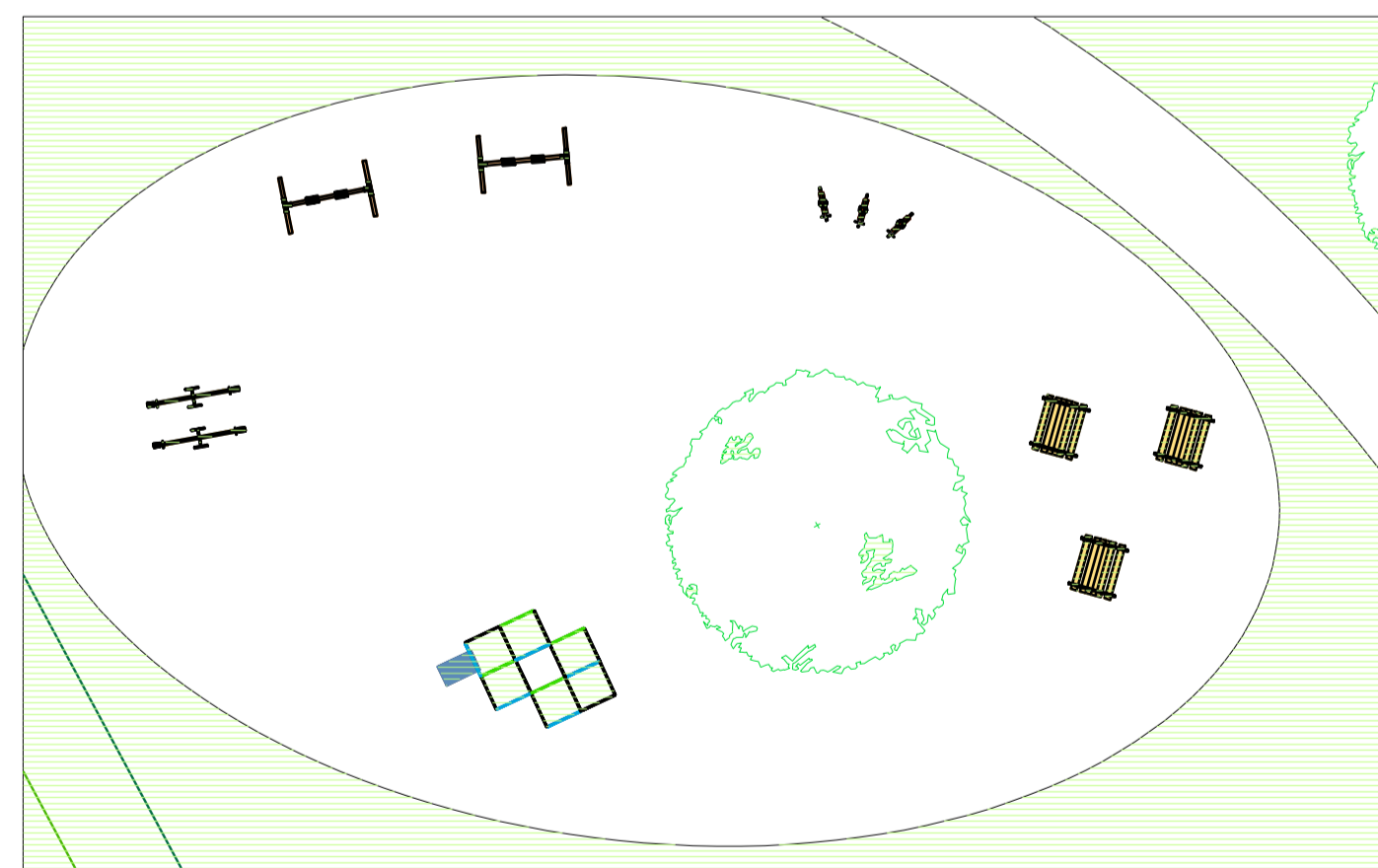

ZONA RISTORO E SERVIZI (scala 1:200)

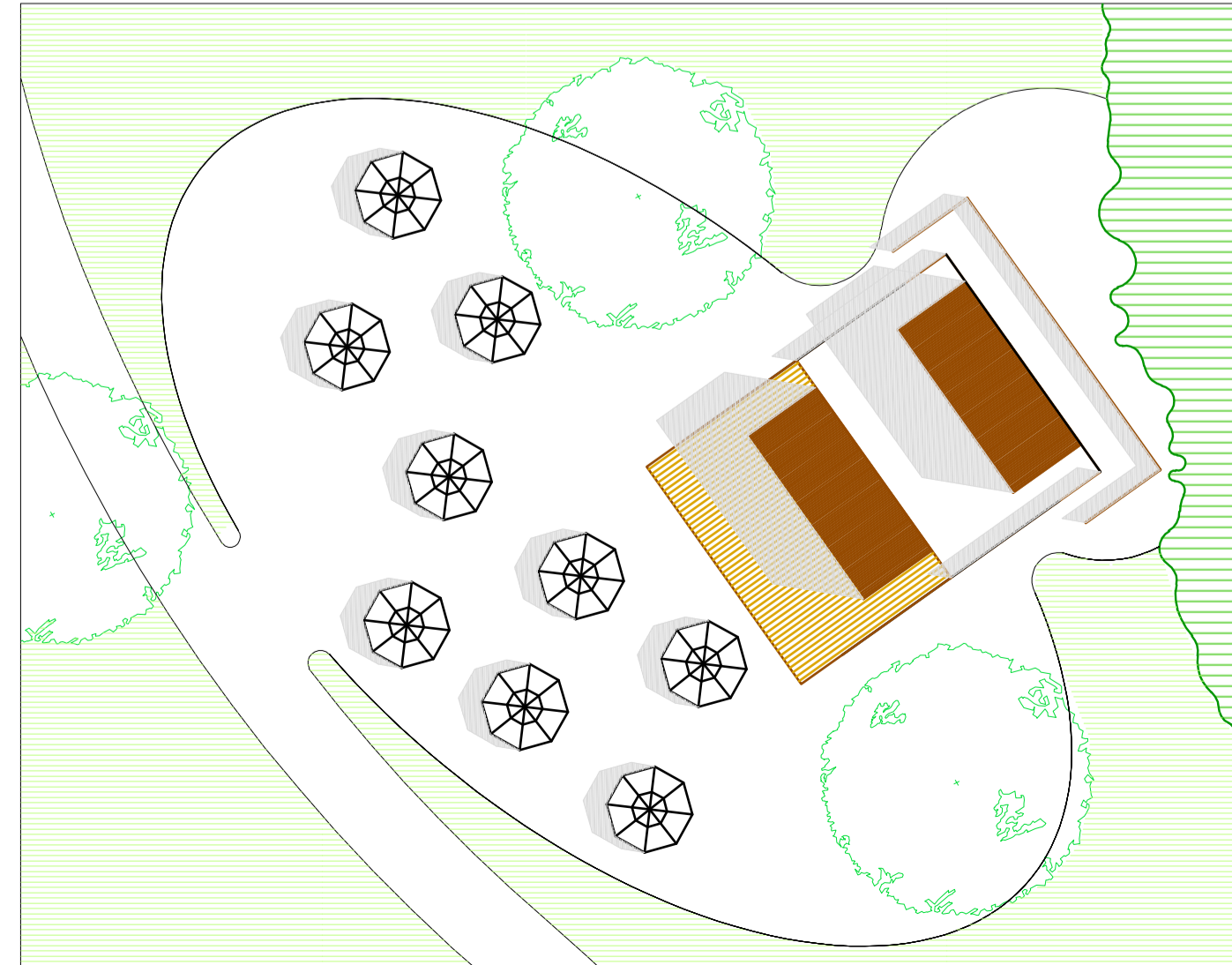



COMUNE DI LUZZARA
PROVINCIA DI REGGIO EMILIA

VARIANTE GENERALE AL PIANO COMUNALE DELLE ATTIVITA' ESTRATTIVE IN ADEGUAMENTO ALLA VARIANTE GENERALE 2002 AL P.I.A.E. DELLA PROVINCIA DI REGGIO EMILIA

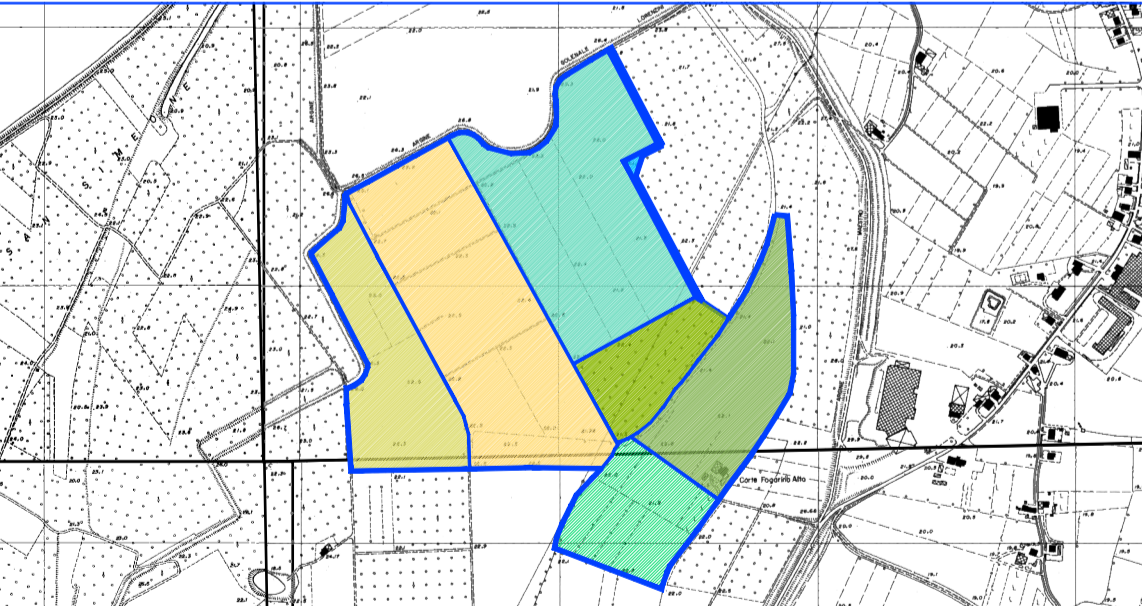

PROGETTAZIONE GENERALE

STUDIO BININI - ARCHITETTI & INGEGNERI ASSOCIATI
Ing. Tiziano Binini
Arch. Silvio Binini
Ing. Giovanni Frati
Arch. Marco Dentì
Ing. Isabella Catti

CONSULENZA GEOLOGICA E GEOTECNICA

Dott. Geol. Roberto Parilli
GEOLOS S.R.L.
v. Emilia all'Angelo 14, RE

CONSULENZA PROGETTAZIONE FORESTALE

Dott. Geol. Paolo Romoli
v. Palermo 20
REGGIO EMILIA

ELABORATI DI PROGETTO

PARTICOLARI PERCORSI ED ATTREZZATURE

Tavola

P.14

Scala
1:500, 1:200, 1:100, 1:50, 1:20

00 Emissione

Gennaio 2005

STUDIO BININI - ARCHITETTI & INGEGNERI ASSOCIATI
STUDIO BININI - via Gazzola, 4 - 42100 Reggio Emilia - tel. 0522/860076-860086 - fax 0522/860057 - E-mail: studio.binini@studiobinini.it